

Φ16

蜂鸣器

H008-R-24

ブザー
Buzzer



● 特点 Features

- * 整体式设计，结构巧妙，使用可靠，坚固耐用；
- * 全系列轻质，低功耗，转换效率高，具备IP40保护等级；
- * 安装孔径16mm，外观尺寸矩形框18X24mm；
- * 一体化デザイン、構造が優れて、信頼性が高く、耐久性が良い。
- * 全シリーズが軽質、低消耗、転換効率が高く、IP40保護レベルを持つ。
- * 取付孔径16mm、外観サイズ長方形ボックス18X24mm；
- * Integrated design, crafty structure, reliable performance, high sturdiness and durability.
- * Full line, light, low power, high conversion frequency, with Protection Class of IP40;
- * Diameter of mounting recess: 16mm, External dimension of rectangular box: 18X24mm;

符合标准

低压开关设备和控制设备总则
IEC60947-1 : 2001 GB 14048.1-2006
控制电路电器和开关元件
IEC60947-5-1 : 2003 GB 14048.5-2008

● 关于选型 About selection

| | |
|----------|----------|
| 型号 Model | 颜色 Color |
| H008 | R |

● 技术特性 Technical Features

| | |
|---|---------------------------------|
| 相比漏电起痕指数 Comparative Tracking Index | CTI≥100 |
| 高度 Height | ≥40cd/m2 |
| 连续工作寿命 Continuous Working Life | ≥30000小时 |
| 额定绝缘电压 Ui Rating Insulation Voltage Ui | AC2500V |
| 工频耐压 Power Frequency Withstand Voltage | AC2000V 1分钟 AC2000V 1 minute |
| 额定工作电流 Ie Rating Operating Current Ie | 蜂鸣器≤40mA Buzzer≤40mA |
| 允许电压波动 Allowed Voltage Fluctuation | ±20% (6V ±10%) |
| 额定绝缘电阻 Rating Insulation Resistance | 在500V直流时≥10MΩ ≥10MΩ (500VDC) |

● 工作环境 Environment

| | |
|---|---|
| 工作温度(周围空气温度) Operating Temperature (Ambient Air Temperature) | -25°C~+55°C |
| 储藏温度 Storage Temperature | -30°C~+85°C |
| 工作湿度 Operating Humidity | ≤85%RH |
| 安装类别 Mounting Category | Ⅲ类配电及控制水平 Class III power distribution and control level |
| 安装极限高度 Mounting Height Limit | 海拔2000m Altitude: 2000m |
| 污染等级 Pollution Degree | 3级 (能在有导电性污染, 或由于凝露使干燥的非导电性污染变成导电性污染的湿热环境下正常工作) Degree 3 (can operate normally in hot and humid environment that has conductive pollution or will have conductive pollution changed from dry non-conductive pollution due to condensation) |

● 外形图 Dimensions

单位:mm

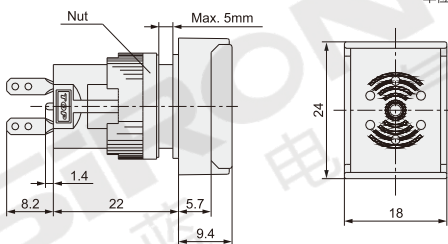

● 关联产品 Related Products



附件类/P.577
Accessories/P.577

按钮盒/P.579
Button Box/P.579



询问胜蓝
0755-8886 0059 当日出货

● 结构图 Structural Drawing

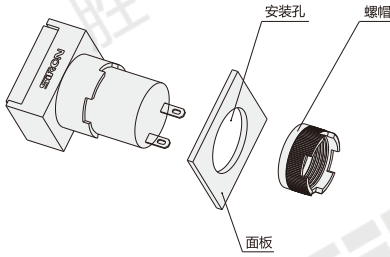

● 安装尺寸 Mounting Dimension

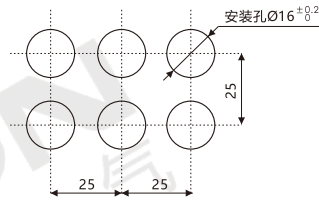

注: 以上为推荐最小安装尺寸, 密集安装时可根据情况适当减小安装距离, 但可能使得安装及接线困难。

Note: The above is the recommended minimum mounting dimension. In case of high density mounting, the mounting distance may be reduced appropriately according to the situation. However, the mounting and wiring may be hard.

● 接脚定义 Pin definition

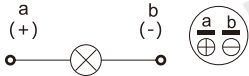

▶ 触点 Touch spot

采用优质银氧化锡合金材料制成, 接线端子采整体镀金0.3um。减少了触点与触点、触点与接片之间接触电阻; 增加了抗腐蚀及抗氧化的能力; 保证了产品的可靠通断, 延长了产品的使用寿命。

Contact: Made of high quality silver tin oxide alloy; the terminal blocks are wholly gilded (0.3um). Reduced contact resistance between contacts as well as contact and contact pin; increased corrosion resistance and oxidation resistance; ensured product reliability, prolonged useful life of product.

分类 classification

T 总线模块
Bus module

T 端子台
Terminal station

Y 电气控制
Electrical control

X 连接电缆
Connecting cable

H 电气配件
Electrical fittings

P 开关电源
Switching power supply

G 辅材配件
Auxiliary fittings

F 气动附件
Pneumatic accessories