

# 底部背光源 K716系列

下部バックライト  
Bottom backlight

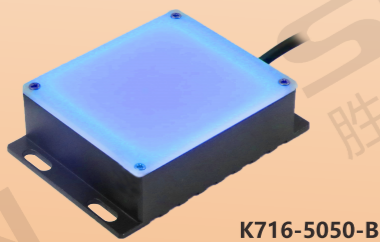
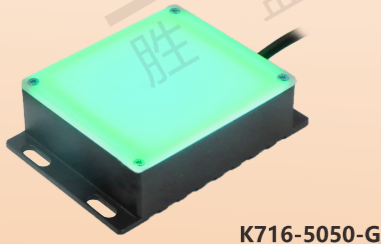

散热好

轻量化设计

均匀性好

亮度高

询问胜蓝

0755-8886 0059

当日出货

## 特点 Features

- \* 采用轻量化设计;
- \* 散热性能更优越;
- \* 采用进口超薄贴片式LED设计;
- \* 能够有效提高光源的亮度和均匀性。
- \* 轻量化设计を採用。
- \* より良い熱放散性能;
- \* 輸入された超薄型SMDLEDデザインを採用;
- \* 光源の明るさと均一性を効果的に向上させることができます。
- \* Adopt lightweight design;
- \* Better heat dissipation performance;
- \* Adopt imported ultra-thin SMD LED design;
- \* It can effectively improve the brightness and uniformity of the light source.

## 关于选型 About selection

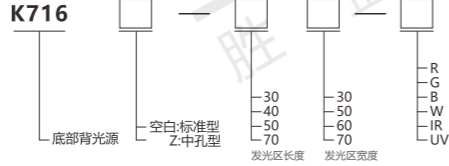

选型举例: K716-5050-R 表示 K716系列, 标准型, 发光区长度为50mm, 发光区宽度为50mm, 光源颜色为红色。

注: 1. 线长0.5M; 2. R-红色; G-绿色; B-蓝色; W-白色; IR-红外; UV-紫外。

标准型		mm																		
发光区长度	30	30	40	50	50	70	80	100	120	130	150	160	180	200	200	250	297	300	300	
发光区宽度	30	60	30	50	80	70	80	100	120	130	150	100	180	120	160	200	250	182	250	300

中孔型		mm									
发光区长度	88	120	150	200	200	200	250	300	300	400	400
发光区宽度	88	80	100	120	160	200	190	250	298	300	400

## 应用案例 Applications

金属元件计数

用背光源照射加上偏正镜, 突出正级, 提高背景对比度



饮料液位检测

采用背光源照射, 使饮料液位轮廓清晰可见



## 均匀性分布图 Uniformity distribution map

暗 视野: 100×100mm



亮 视野: 100×100mm

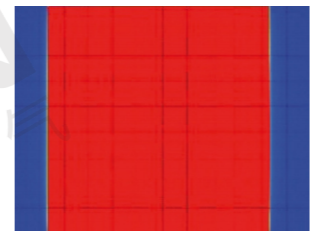

## 照度特性图

Illumination characteristic graph

型号: K716-100100-W

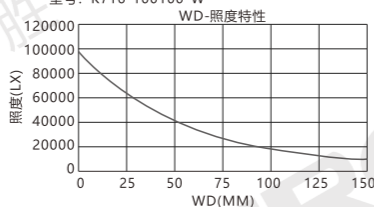

## 规格参数 Specifications

名称 Name	底部背光源 Bottom backlight
外观 Appearance	
电压 Voltage	24V DC
工作温度 Operating temperature	-10~+60°C
工作湿度 Working humidity	20~85%(无雾化)
控制器 Controller	模拟控制器; 数字控制器; 频闪控制器
应用范围 Scope of application	产品尺寸检测; 产品轮廓检测; 药品饮料液位检测
波长及色温 Wavelength and color temperature	白色W: 6500K 红色R: 620~630nm 绿色G: 525~530nm 蓝色B: 465~470nm 红外IR: 850~940nm 紫外UV: 365~395nm

## 关联产品 Related products

控制器 Controller			
	模拟控制器 K790/P065	数字控制器 K791/P067	频闪控制器 K792/P069
延长线 Extension cord	 K019-2-XXXX (根据客户需求订购, 订购前请先确认长度。)		

## 外形图 Dimension

K716-3030 mm

功率 Power	R	0.7W	G/B/W	1.1W
-------------	---	------	-------	------

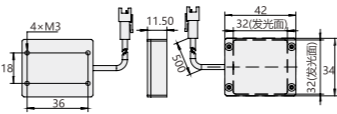

K716-4030 mm

功率 Power	R	1.2W	G/B/W	1.5W
-------------	---	------	-------	------

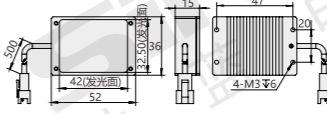

K716-5050 mm

功率 Power	R	2.1W	G/B/W	2.7W
-------------	---	------	-------	------

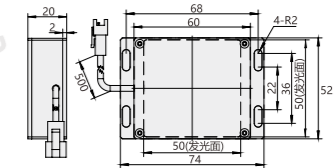

K716-5080 mm

功率 Power	R	3.7W	G/B/W	6.9W
-------------	---	------	-------	------

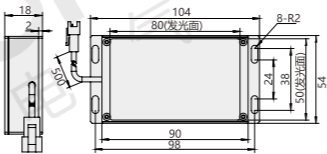

K716-3060 mm

功率 Power	R	2.5W	G/B/W	3.5W
-------------	---	------	-------	------

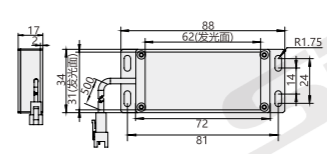

K716-7070 mm

功率 Power	R	3.6W	G/B/W	6.2W
-------------	---	------	-------	------

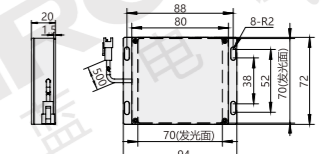

K716-8080 mm

功率 Power	R	4.6W	G/B/W	8.0W
-------------	---	------	-------	------

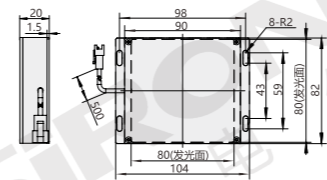

K716-100100 mm

功率 Power	R	7.9W	G/B/W	12.5W
-------------	---	------	-------	-------

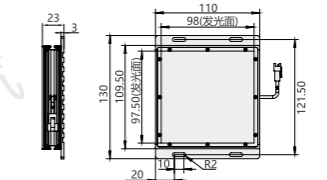

K716-120120 mm

功率 Power	R	8.5W	G/B/W	14.6W
-------------	---	------	-------	-------

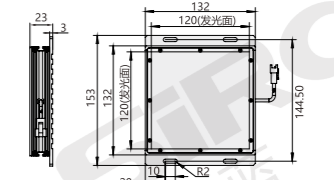

K716-130130 mm

功率 Power	R	10.3W	G/B/W	16.0W
-------------	---	-------	-------	-------

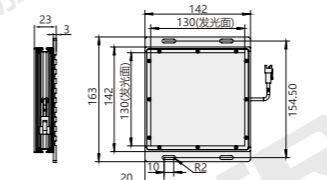

K716-150150 mm

功率 Power	R	12.6W	G/B/W	18.5W
-------------	---	-------	-------	-------

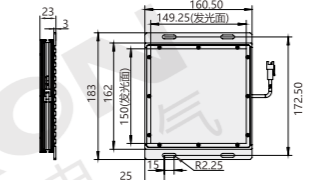

K716-160100 mm

功率 Power	R	10.9W	G/B/W	16.8W
-------------	---	-------	-------	-------

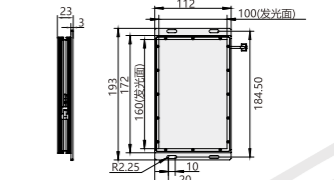

## 分类 classification

光纤传感器  
Optical fiber sensor

激光传感器  
Laser light sensor

光电传感器  
Photoelectric sensor

接近传感器  
Proximity sensor

区域传感器  
Area sensor

测量传感器  
Measuring sensor

磁性传感器  
Magnetic sensor

辅助配件  
Auxiliary accessories

镜头  
Camera lens

光源  
Light source

K716-180180 mm

功率 Power	R	19.5W	G/B/W	28.2W
-------------	---	-------	-------	-------

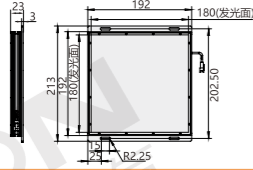

K716-200120 mm

功率 Power	R	23.2W	G/B/W	24.5W
-------------	---	-------	-------	-------

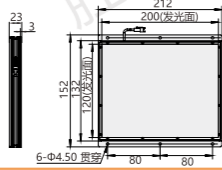

K716-200160 mm

功率 Power	R	18.3W	G/B/W	27.1W
-------------	---	-------	-------	-------

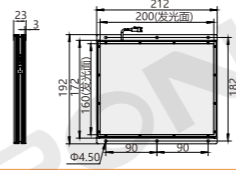

K716-200200 mm

功率 Power	R	20.3W	G/B/W	33.8W
-------------	---	-------	-------	-------

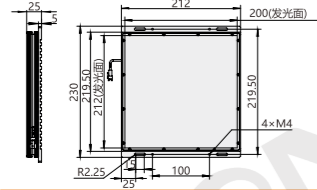

K716-250250 mm

功率 Power	R	32.5W	G/B/W	43.4W
-------------	---	-------	-------	-------

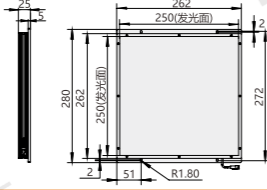

K716-297182 mm

功率 Power	R	31.1W	G/B/W	40.2W
-------------	---	-------	-------	-------

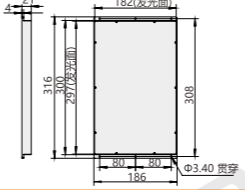

K716-300250 mm

功率 Power	R	48.3W	G/B/W	66.4W
-------------	---	-------	-------	-------

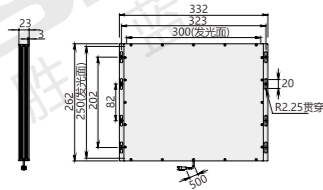

K716-300300 mm

功率 Power	R	48.4W	G/B/W	66.5W
-------------	---	-------	-------	-------

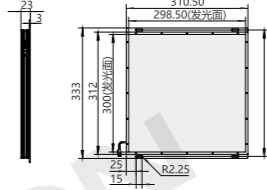

K716Z-8888(中孔型) mm

功率 Power	R	5.4W	G/B/W	5.7W
-------------	---	------	-------	------

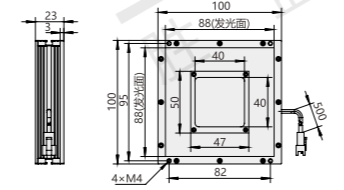

K716Z-12080(中孔型) mm

功率 Power	R	4.1W	G/B/W	4.3W
-------------	---	------	-------	------

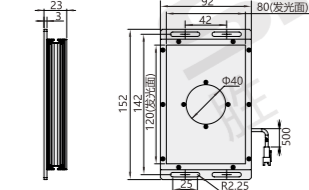

K716Z-150100(中孔型) mm

功率 Power	R	7.3W	G/B/W	7.7W
-------------	---	------	-------	------

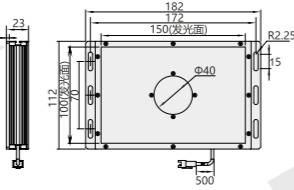

K716Z-200120(中孔型) mm

功率 Power	R	19.4W	G/B/W	25.2W
-------------	---	-------	-------	-------

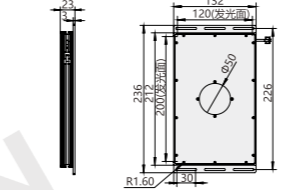

K716Z-200160(中孔型) mm

功率 Power	R	23.5W	G/B/W	28.1W
-------------	---	-------	-------	-------

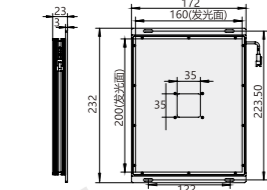

K716Z-200200(中孔型) mm

功率 Power	R	26.1W	G/B/W	31.5W
-------------	---	-------	-------	-------

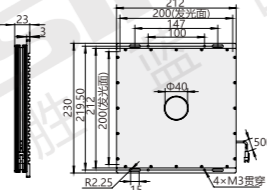

K716Z-250190(中孔型) mm

功率 Power	R	26.8W	G/B/W	28.3W
-------------	---	-------	-------	-------

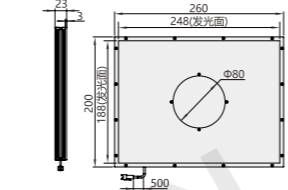

光纤传感器  
Optical fiber sensor

激光传感器  
Laser light sensor

光电传感器  
Photoelectric sensor

接近传感器  
Proximity sensor

区域传感器  
Area sensor

测量传感器  
Measuring sensor

磁性传感器  
Magnetic sensor

辅助配件  
Auxiliary accessories

镜头  
Camera lens

光源  
Light source

K716Z-300250(中孔型) mm

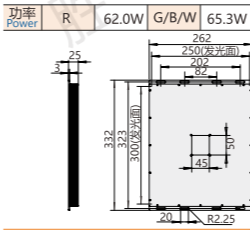

K716Z-300300(中孔型) mm

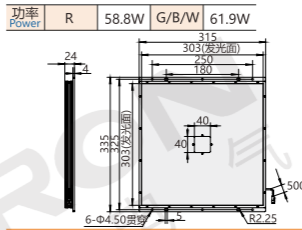

K716Z-400300(中孔型) mm

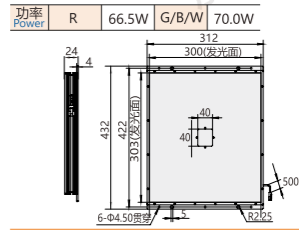

K716Z-400400(中孔型) mm

